

# HYDRO-GEAR MODEL 1015-1039R CUSTOMER MODEL 543209

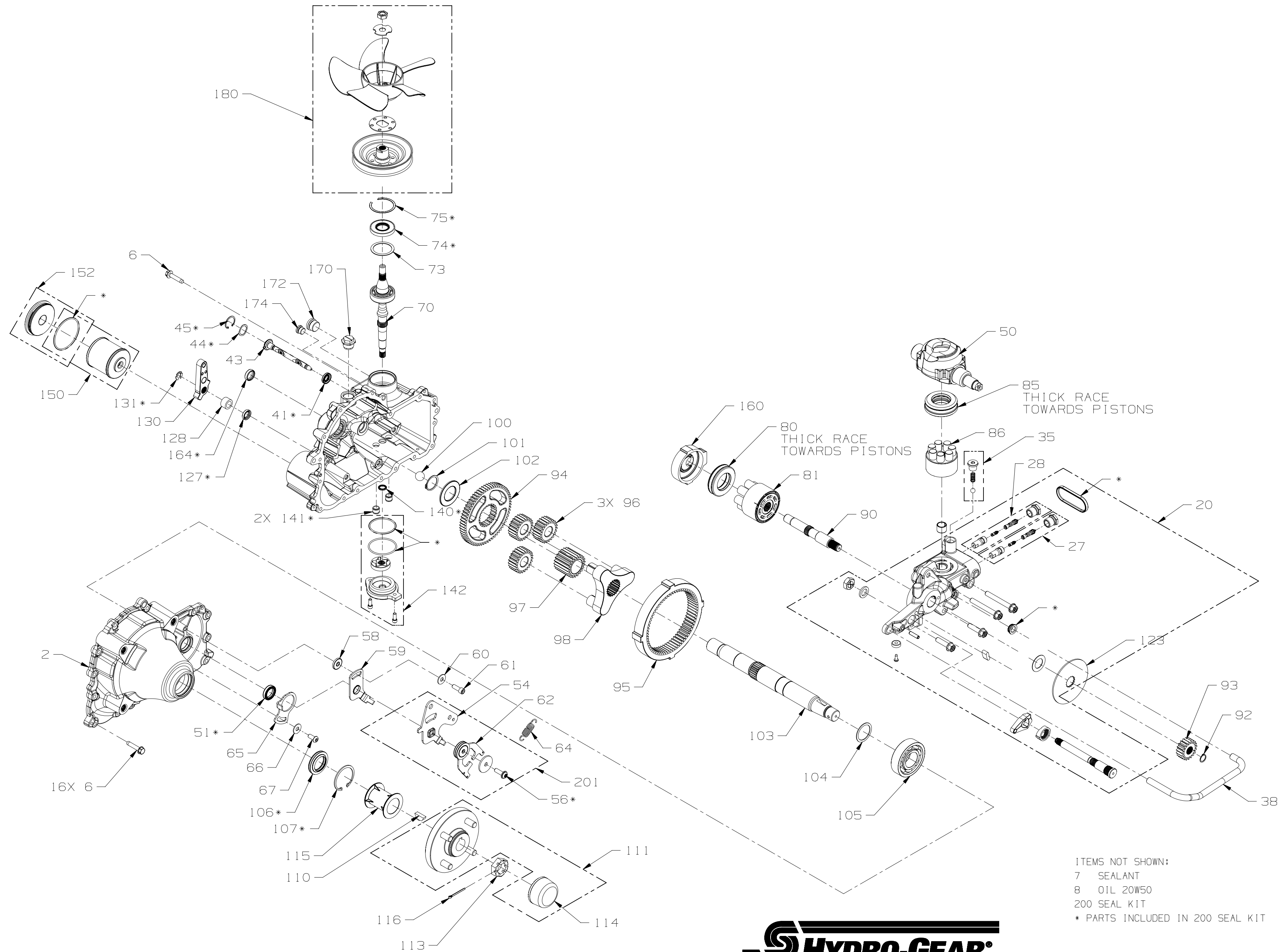

ITEMS NOT SHOWN:  
 7 SEALANT  
 8 OIL 20W50  
 200 SEAL KIT  
 \* PARTS INCLUDED IN 200 SEAL KIT



HYDRO-GEAR MODEL: 1015-1039R

CUSTOMER MODEL: 543209

ITEM #	PART #	PREFERRED PROD & SERV DESC	QTY
1	71947	KIT, HOUSING, MAIN, RH - HOUSING, MAIN, RH MACHINE (1) - NEEDLE BEARING, 17 X 24 X 15 (1) - BEARING, NEEDLE 1.125 X 1.375 X 1.000 (1) - PIN (2) - PLUG (2) - BUSHING, 35 X 39 X 20 (1) - LABEL, ZT-5400 POWERTRAIN - SCREW, HEX FLANGE, 5/16-18 X 1.5 - BUSHING, STEEL, 16 X 17 X 12	1
2	71949	KIT, HOUSING, SIDE, RH - HOUSING, SIDE RH MACHINE (1) - BUSHING, 35 X 39 X 20 (1) - INSERT, THREADED, LOCKING 1/2-13 X 1.00 (4) - SCREW, HEX FLANGE, 5/16-18 X 1.5	1
6	53987	SCREW, HEX FLANGE 5/16-18 X 1.50	17
7	50928	TUBE, SEALANT	1
8	DIL, 20W50		1.2 gal
20	71996	KIT, CENTER SECTION - CENTER SECTION, RH (1) - BOLT, HEX FLANGE 3/8-16 X 3.00 (2) - SCREW, HEX FLANGE HEAD 3/8-16 1.5 (2) - BUSHING, 2.2 X 25.4 X 22.2 (1) - BUSHING 17 X 20.2 X 15 (1) - SEAL, PLUG 1.375 X 250 X 3.477 (1) - ASSEMBLY, SEAT, CHECK (2) - SHOCK VALVE ASSEMBLY (200 BAR) (1) - SHOCK VALVE ASSEMBLY (200 BAR) (1) - RETAINER, CHECK SPRING (2) - SPRING, COMPRESSION SHOCK CHECK (2) - GROMMET (1) - MAGNET, RING (1) - BOLT, SELF TAPPING 1/2-20 X 5 (1) - PIN, HARDENED GROUND PROD DOWEL 1/4 X 1 (1) - SHAFT, BRAKE (1) - CAM, SPRUNGED (1) - PUCK, CAM (1) - ROTOR, BRAKE (1) - PUCK, BRAKE (1) - WASHER, FLAT, .63 X 1.0 X 1.25 (1) - NUT, HEX 5/8-18 W/PATCH (1) - WASHER, .89 X 1.50 X .34 (1)	1
28	71952	KIT, SHOCK VALVE - SHOCK VALVE ASSEMBLY (200 BAR) (1) - ASSEMBLY, SEAT, CHECK (1) - RETAINER, CHECK SPRING (1) - SPRING (1)	1
29	71952	KIT, SHOCK VALVE - SHOCK VALVE ASSEMBLY (200 BAR) (1) - ASSEMBLY, SEAT, CHECK (1) - RETAINER, CHECK SPRING (1) - SPRING (1)	1
35	71999	KIT, CHARGE RELIEF - BALL, .98 (1) - SPRING, HELICAL COMPRESSION (1) - SCREW, 5/8-11 X .50 (1)	1
38	52983	TUBE, FILTER, RH	1
41	53197	SEAL, LIP 12 X 24 X 5 TC	1
43	54335	ASSEMBLY, ACTUATOR BYPASS	1
44	53321	SPRING, WAVE	1
45	53322	RING, RETAINING, HO-100	1
50	52972	SWASHPLATE, 16CC, MACHINED	1
51	52989	SEAL, LIP, 22 X 32 X 7	1
54	53221	ARM, CONTROL, RH	1
56	51812	TWHS, 5/16-24 X 1.00 (PATCH)	1
58	54315	SPACER, 320X1.00X.179	1
59	51945	ARM, NEUTRAL, RH	1
60	44130	WASHER, .34X.88X.06	1
61	51616	SHCS 5/16-24 X .875 (PATCH)	1
62	52434	ASSEMBLY, RTN, UNI-DIRECTIONAL (CW)	1
64	51833	SPRING, EXTENSION	1
65	53189	PLATE, STOP, RH	1
66	44130	WASHER, .34X.88X.06	1
67	53619	MHCS 5/16-18 X .75	1
70	71941	KIT, INPUT SHAFT - SHAFT, INPUT (1) - BEARING, BALL 25.4 X 52 X 15 (1) - RING, RETAINING WIRE, .002 ID (1)	1
73	51279	SPACER	1
74	51280	SEAL, LIP 25 X 52 X 7 TC	1
75	52650	RING, RETAINING, INTERNAL	1

ITEM #	PART #	PREFERRED PROD & SERV DESC	QTY
80	53341	BRG, THRUST (2) 42X68X16, PLASTIC CAGE	1
81	72159	KIT, CYLINDER BLOCK 21cc - BLOCK, CYLINDER 21cc (1) - WASHER, THRUST (7) - PISTON (7) - SPRING, HELICAL COMPRESSION (7)	1
85	52991	BRG, THRUST 35 X 70 X 22	1
86	72158	KIT, CYLINDER BLOCK (16cc) - BLOCK, CYLINDER 16cc (1) - SPRING, COMPRESSION (7) - PISTON (7) - WASHER, THRUST (7)	1
90	52992	SHAFT, MOTOR	1
92	44145	RING, RETAINING	1
93	52994	GEAR, 16T	1
94	52995	GEAR, 60T	1
95	53988	GEAR, RING, 68T	1
96	54483	GEAR, PLANET, 23T	3
97	53000	GEAR, SUN, 22T	1
98	53001	CARRIER	1
100	53002	BALL, THRUST, .75	1
101	53003	RING, RETAINING, 1.25	1
102	53004	SPACER, THRUST, AXLE	1
103	53160	SHAFT, AXLE	1
104	53006	WASHER, 1.40 X 1.75 X .05	1
105	53007	BEARING, BALL 35 X 80 X 21 (6307)	1
106	53008	SEAL, LIP 1.375 X 2.062 X 0.250	1
107	50859	RING, RETAINING INTERNAL	1
110	51796	KEY, SHAFT, AXLE	1
111	72101	KIT, HUB 4 BOLT - HUB, TAPER 1.25 4 BOLT (1) - STUD, 1/2-20 X 1.55 (RIB NECK) (4) - CAP, AXLE (1)	1
113	51821	NUT, HEX 1-20 SLOTTED	1
114	53724	CAP, AXLE	1
115	53387	TUBE, AXLE 1.40 X 2.22	1
116	51822	PIN, COTTER, .964 X 2 EXTENDED PRONG	1
123	53012	ROTOR, BRAKE	1
127	53015	SEAL, .56 X .88 X .19	1
128	53356	SPACER 57 X .89 X .53	1
130	53018	HANDLE, ACTUATING	1
131	53019	RING, RETAINING	1
140	53620	SEAL, .56 X .88 X .29 LVC	1
141	52157	TUBE, PUSH CHING	2
142	71942	KIT, CHARGE COVER - GEROTOR ASSEMBLY (3.7 cc/rev) (1) - O-RING -137, 103 X 2.175 (1) - HOUSING, CHARGE PUMP (1) - SHCS 1/4-20X.625 (2) - O-RING -137, 103 X 2.050	1
150	71943	KIT, FILTER - FILTER, INTERNAL (1) - O-RING -148, 2.737 X 1.03 X 2.881 (1)	1

ITEM #	PART #	PREFERRED PROD & SERV DESC	QTY
152	71944	KIT, FILTER PLUG - PLUG, FILTER (1) - O-RING -148, 2.737 X 1.03 X 2.881 (1)	1
160	53026	PLATE, MOTOR, SWASH	1
164	53031	SEAL, PLUG	1
170	9005000-8700	PLUG, 7/8-14, PLASTIC	1
172	9005110-8700	PLUG, 7/8-14, METAL	1
174	9005110-5600	PLUG, 9/16-18, METAL	1
180	71906	KIT, FAN/PULLEY - ASSEMBLY, HUB/PULLEY, 5.0" (1) - FAN, 9.0" (5 BLADE, CW) (1) - WASHER, OD SLOTTED, .53 X 1.63 X .06 (1) - NUT, HEX JAM 1/2-20 W/PATCH (1) - SPACER, ANTI-ROTATE 1.008 X 2.200 X .082 (1)	1
200	71945	KIT, SEAL - SEAL, PLUG 1.375 X .250 X 3.477 (1) - GROMMET (1) - SEAL, LIP 12 X 24 X 5 (1) - O-RING .010 .070 X .239 (2) - SPRING, WAVE (1) - RING, RETAINING, HO-100 (1) - SEAL, LIP 22 X 32 X 7 TC (1) - TWHS 5/16-24 X 1.00 (PATCH) (1) - SEAL, LIP 25 X 52 X 7 (1) - RING, RETAINING INTERNAL (1) - SEAL, LIP 1.375 X 2.062 X 0.250 (1) - RING, RETAINING (1) - PIN, COTTER, .964 X 2 EXTENDED PRONG - SEAL, LIP .562 X .875 X .187 (1) - RING, RETAINING EXTERNAL, .438 (1) - SEAL, LIP .500 X .688 X .094 (1) - TUBE, PUSH CHING, .500 X .450 (2) - O-RING, -139, 103 X 2.175 (1) - O-RING -137, 103 X 2.050 (1) - O-RING -148, 2.737 X 1.03 X 2.881 (1) - SEAL, LIP 15 X 24 X 7 (1) - SEAL, PLUG .945 X .250 (1)	1
201	72001	KIT, RTN, RH ROTATION B - ARM, CONTROL, RH (1) - TWHS 5/16-24 X 1.00 (PATCH) (1) - ASSM, RTN, UNI-DIRECTIONAL (CW) (1) - WASHER, FLAT .34 X 1.50 X .12 (1)	1