



# SERVICE BULLETIN

**Date:** 8/5/2005

**Number:** SB0503

**Subject:** Deck Lift Rod Assembly for 52K23X

**Details:** The deck lift rod assembly for the Encore X-treme 52K23X has been changed on units with serial # 50242 and above. The complete assembly now consists of the following components:

| Item # | Qty | Part # | Description     |
|--------|-----|--------|-----------------|
| 1      | 1   | 533060 | Deck Lift Rod   |
| 2      | 1   | 533084 | 1/2" Rod End    |
| 3      | 1   | 533083 | 1/2" Clevis End |
| 4      | 2   | 104755 | 1/2"-20 Jam Nut |

Following is the required hardware for fastening the deck lift rod assembly to the unit:

| Item # | Qty | Part # | Description          |
|--------|-----|--------|----------------------|
| 5      | 2   | 363174 | Eyebolt Spacer       |
| 6      | 1   | 105259 | 3/8 SAE Flat Washer  |
| 7      | 2   | 100295 | 3/8-16 x 1-3/4" HHCS |
| 8      | 2   | 109007 | 3/8-16 Whizlock Nut  |
| 9      | 1   | 104257 | 3/8-16 Nyloc Nut     |

When installing the lift rod assembly, make certain that the bend in the rod is pointed downward toward the deck in order to prevent the rod from interfering with the height adjustment pin.

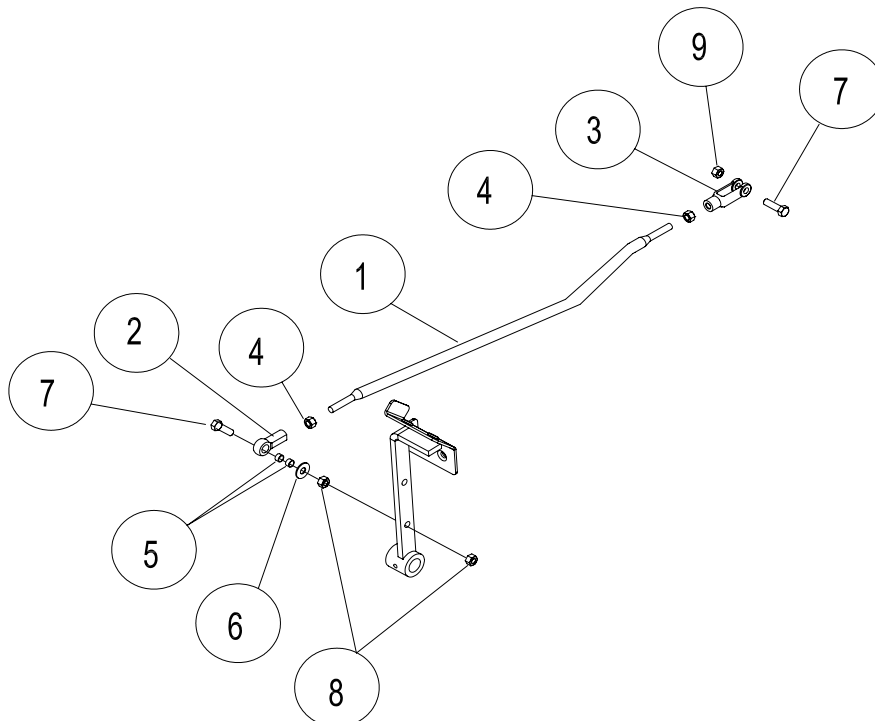

Please make note of these changes in your 52 X-treme illustrated parts manual.