



SERVICE BULLETIN

Date: 4/5/2004

Number: SB0403

Subject: Z60 Lift Mount Recall

Component Recall!

Details: The Lift Mount for the 60K25Z, part # 422128, is being **RECALLED**. It has been discovered that on some Z60 machines, the corner of the Lift Mount may actually touch the blade drive belt when the deck height position is in the 3-1/2" and above positions. This in turn may cause premature wear or breakage on the blade drive belt.

Please replace this component (as shown in diagram below) via the standard warranty procedure:

- 1 Order replacement Lift Mount, part # 422128 from your distributor.
- 2 Replace existing lift mount with modified replacement Lift Mount, 422128. Encore will pay 1/2 hour labor for this replacement.
- 3 Ship original lift mount back to your distributor so that it may be returned to Encore. Please include necessary warranty information in box with part being sent back.
- 4 Submit Warranty Claim Form via USPS or online at www.encoreequipment.com.

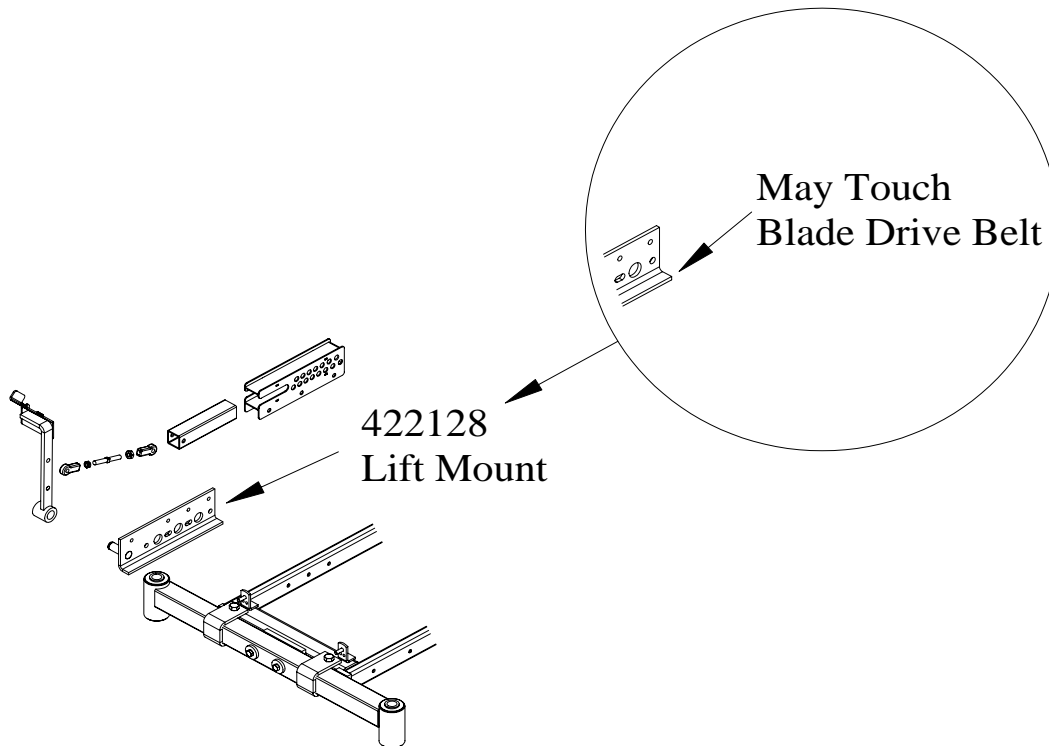

Units with the model # of 60K25Z and the following serial # 's have been repaired "in house" :

Serial # 's 47579, 47580, 47639-47642, 47815 and above

Any 60K25Z with serial # other than what is listed above must have its lift mount, part # 422128, replaced. Please notify all your customers who have the 60K25Z of this recall.