



SERVICE BULLETIN

Date: 5/14/2002

Number: SB0202

Subject: Deck Lift Rod on Z-34 Riders

Details:

In a continued effort to improve the ease of deck adjustment on the Z-34, there has been a change made to the Deck Lift Rod.

Please make the following changes to the Z-34 Parts Manual in the Main Frame Assembly section, figure 1 of 2.

Item # 55 should be changed to part # 343154. In addition to this change, you will need to also add the following parts:

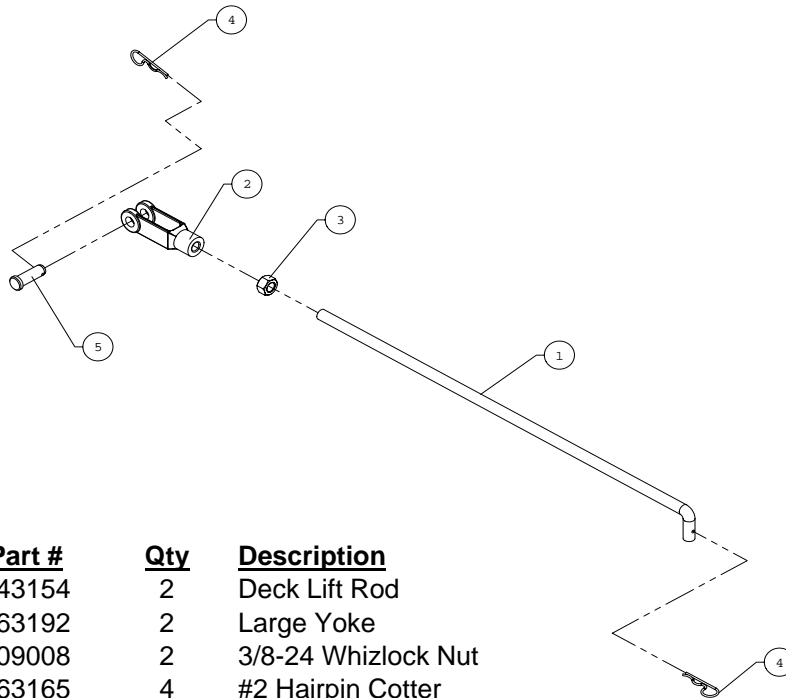

<u>Item</u>	<u>Part #</u>	<u>Qty</u>	<u>Description</u>
1	343154	2	Deck Lift Rod
2	363192	2	Large Yoke
3	109008	2	3/8-24 Whizlock Nut
4	363165	4	#2 Hairpin Cotter
5	363196	2	Large Clevis Pin

Objective: By adjusting the length of the Deck Lift Rod, you can change the side to side level of the deck and also set the front to back pitch.

Please make note of this change in your Parts and Service Manuals.

Thank you,
Encore Service Department